

GATWICK TUG CROSSING POINTS

(Not available for use during Low Visibility Operations)

Check AIRDAT
for latest version

ALPHA

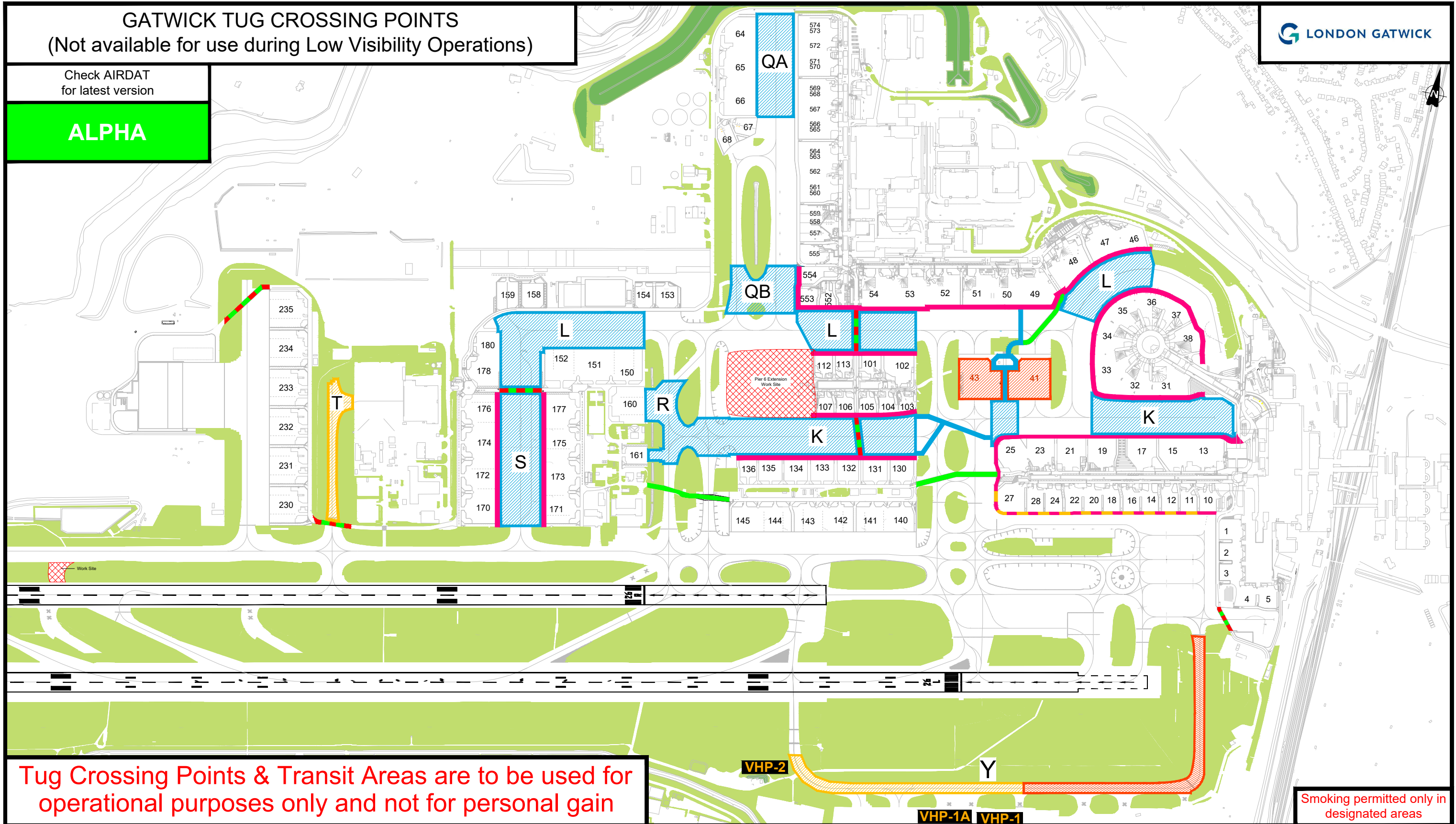

Tug Crossing Points & Transit Areas are to be used for operational purposes only and not for personal gain

Smoking permitted only in designated areas

Contact Telephone Numbers:

Emergency 222 (from Stand telephone)
Emergency 01293 501222 (from a mobile)

ALL airside incidents must be reported via one of the above numbers

Airfield Operations 3090 (from Stand telephone)
Airfield Operations 01293 503090 (from a mobile)
ATC 01293 601031
Engineering Faults 1111 (from Stand telephone)
Engineering Faults 01293 501111 (from a mobile)

ATC Radio Frequencies:

Tower 124.230MHz
Ground 121.805MHz
Standby (As directed by ATC) 134.230MHz

All vehicles must maintain a Listening Watch with ATC whilst driving on the manoeuvring area

Maximum Speed Limits:

Airside Roads/Crossings 20 mph (or as locally signed)
Interstand Clearways 5 mph
Manoeuvring Area 40 mph

Key:

- No Free Ranging
- Tug Crossing Areas
- Tug Transit Areas
- Tug Crossing Direct Routes

- Tugs Permitted to cross the double white lines
- Tugs NOT Permitted to cross the double white lines during Northern Runway Operations
- Taxiway Crossing - Controlled
- Taxiway Crossing - Semi-Controlled

Vehicle Holding Point (VHP)