

GATWICK AIRFIELD MAP

Northern Runway 08L/26R Operation

Check AIRDAT
for latest version

ALPHA

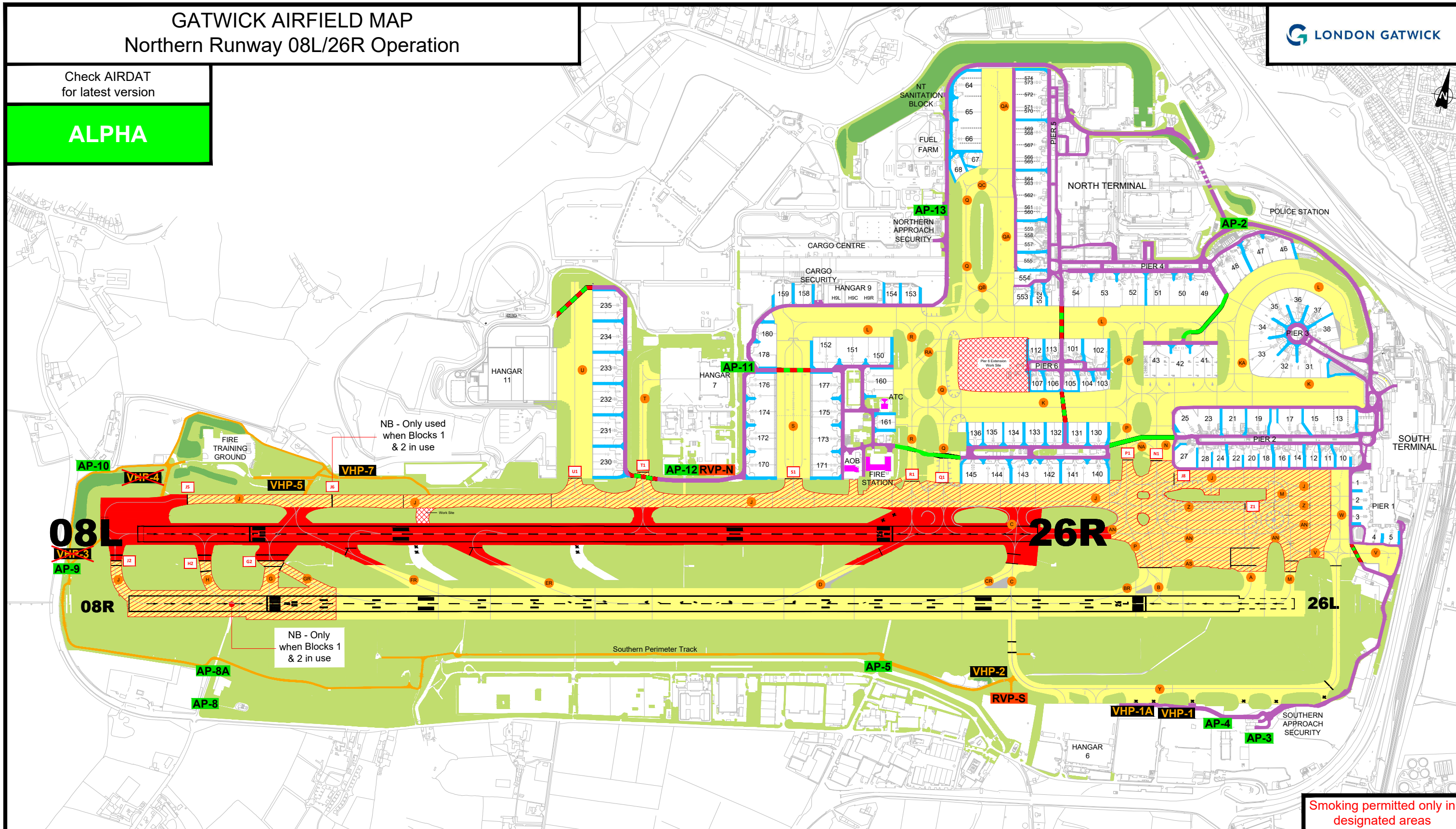

Contact Telephone Numbers:

Emergency 222 (from Stand telephone)
Emergency 01293 501222 (from a mobile)

ALL airside incidents must be reported via one of the above numbers

Airfield Operations 3090 (from Stand telephone)
Airfield Operations 01293 503090 (from a mobile)
ATC 01293 601031
Engineering Faults 1111 (from Stand telephone)
Engineering Faults 01293 501111 (from a mobile)

ATC Radio Frequencies:

Tower 124.230MHz
Ground 121.805MHz
Standby (As directed by ATC) 134.230MHz

All vehicles must maintain a Listening Watch with ATC whilst driving on the manoeuvring area

Maximum Speed Limits:

Airside Roads/Crossings 20 mph (or as locally signed)
Interstand Clearways 5 mph
Manoeuvring Area 40 mph

Key:

- Northern Runway 08L/26R:
No Free Ranging at any time - Controlled by ATC Tower
- No Free Ranging at any time:
Controlled by ATC Tower
- Manoeuvring Area:
Only drivers with a valid Manoeuvring Area licence are permitted to drive on the Manoeuvring area

- Airside (Service) Road
- Interstand Clearway
- Taxiway Crossing - Controlled
- Taxiway Crossing - Semi-Controlled
- Airfield Perimeter Track (Max. Speed 20mph)
(Manoeuvring Area Licence Holders Only)

- Runway Holding Point
- Taxiway Designation
- Rendezvous Point (RVP)
- Access Point (AP)
- Vehicle Holding Point (VHP)
- Vehicle Holding Point (VHP)
Not Available During NR Operation

Smoking permitted only in designated areas