

# GATWICK AIRFIELD MAP

## Main Runway 08R/26L Operation

Check AIRDAT  
for latest version

**ALPHA**

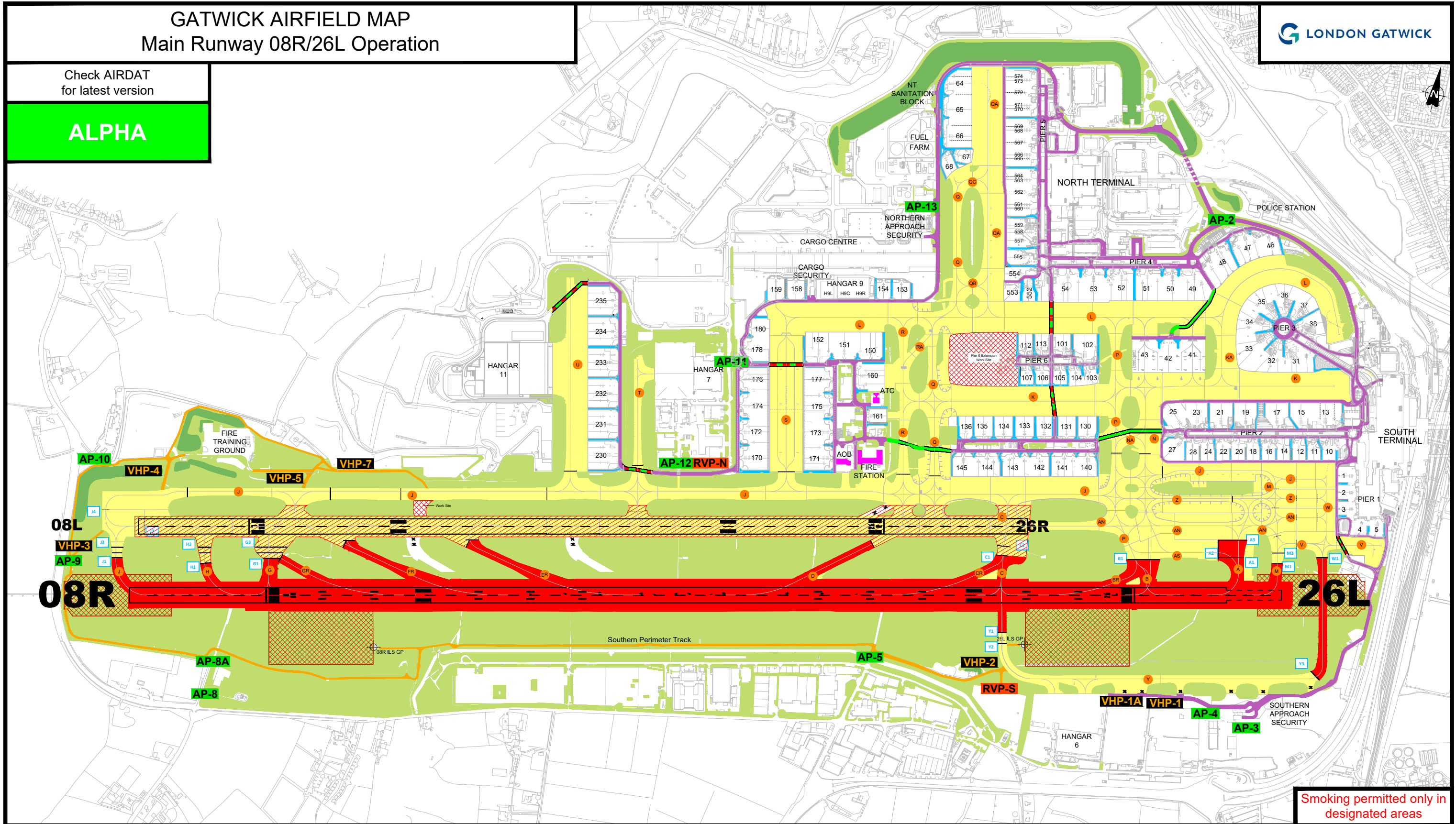

Smoking permitted only in designated areas

<b>Contact Telephone Numbers:</b>	
Emergency	222 (from Stand telephone)
Emergency	01293 501222 (from a mobile)
ALL airside incidents must be reported via one of the above numbers	
Airfield Operations	3090 (from Stand telephone)
Airfield Operations	01293 503090 (from a mobile)
ATC	01293 601031
Engineering Faults	1111 (from Stand telephone)
Engineering Faults	01293 501111 (from a mobile)

<b>ATC Radio Frequencies:</b>	
Tower	124.230MHz
Ground	121.805MHz
Standby (As directed by ATC)	134.230MHz
All vehicles must maintain a Listening Watch with ATC whilst driving on the manoeuvring area	
<b>Maximum Speed Limits:</b>	
Airside Roads/Crossings	20 mph (or as locally signed)
Interstand Clearways	5 mph
Manoeuvring Area	40 mph

<b>Key:</b>	
	<b>ILS Critical Areas:</b> Under no circumstances must anyone enter these Critical Areas without ATC permission
	<b>Main Runway 08R/26L / Yankee Undershoot:</b> No Free Ranging at any time - Controlled by ATC Tower
	<b>Northern Runway 08L/26R:</b> Only GAL approved vehicles can Free Range on 08L/26R - Controlled by ATC Ground
	<b>Manoeuvring Area:</b> Only drivers with a valid Manoeuvring Area licence are permitted to drive on the Manoeuvring Area

	Airside (Service) Road		Runway Holding Point
	Interstand Clearway		Taxiway Designation
	Taxiway Crossing - Controlled		Rendezvous Point (RVP)
	Taxiway Crossing - Semi-Controlled		Access Point (AP)
	Airfield Perimeter Track (Max. Speed 20mph) (Manoeuvring Area Licence Holders Only)		Vehicle Holding Point (VHP)